

ASHP INSTALLATION PERFORMANCE SPECIFICATION

Remove existing gas-fired combi-boiler.

Design, install, test and commission replacement ASHP and associated equipment and controls

- Comply with all relevant standards, including where applicable:
- BS EN 14511: Space heating
 - BS EN 16147: Requirements for Domestic Hot Water (DHW)
 - BS EN 12102-1: Sound power level
 - BS EN 14825: Calculation of seasonal performance
 - BS EN 62108: Capacity for long term operation in general open-air climates
 - MIS 3005-D: Microgeneration Certification Scheme (MCS) requirements for supply, design of heat pump systems
 - MIS 3005-I: Microgeneration Installation Standard for heat pump installation
 - Building Regulations
 - BS 7671 IEE Wiring Regulations

Design temperatures:

- Internal: 20°C
- External: -3°C

Design flow temperature:

- Maximum: < 50°C
- Best practice: < 45°C

Seasonal co-efficient of performance (SCOP): > 4.0

Preferred refrigerant : R290 (GWP: 3)

- Existing radiators:
- Quinn Compla panel radiator
 - TRV and L/S valves
 - See floor plans for sizes
 - Supplied by individual circuits from a manifold located in the Store
 - EXTRA OVER OPTION (if feasible): Provide separate zone control for:
 1. Rooms 1 & 2
 2. Room 3
 3. Room 4

- Smart wireless thermostat control:
- Programming: weekly and daily
 - Weather compensated
 - Compatible with thermostats for zone control
 - EXTRA OVER OPTION: Remote access via App and web-based platform to allow settings to be adjusted
 - EXTRA OVER OPTION: Facility to monitor SCOP and heat energy use

DHW provision for Kitchen sinks, Room 2 Disabled WC washbasin and Art/Utility sink: Storage cylinder heated by ASHP

T2	03.07.25	IWI and secondary double glazing windows to Room 3 added	AG			
T1	24.03.25	Tender issue	AG			
P1	07.03.25	Initial issue	AG			
Rev	Date	Amendment	By Chkd			
0	1	2	3	4	5	6 metres

GROUND FLOOR PLAN

Proposed ASHP - St Andrew's Centre, Hertford

Scale 1:100 @ A3 Date Mar 2025 Drawing no. 25_413 | L | 004_T2

Electrical services schedule:

- Reposition:
- 3 no. double 13A SSOs
 - 4 no. data outlets

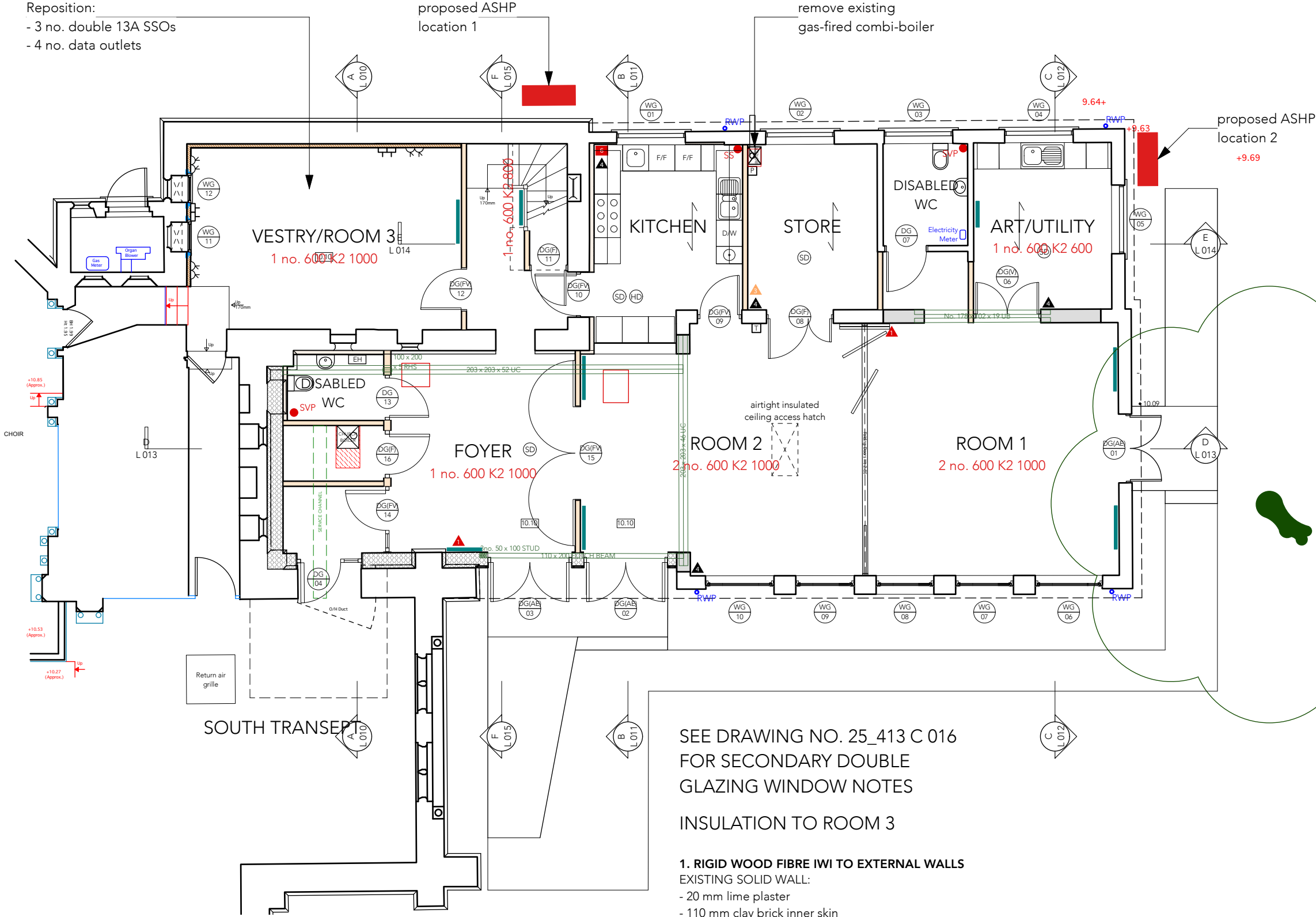

SEE DRAWING NO. 25_413 C 016
FOR SECONDARY DOUBLE
GLAZING WINDOW NOTES

INSULATION TO ROOM 3

1. RIGID WOOD FIBRE IWI TO EXTERNAL WALLS

EXISTING SOLID WALL:

- 20 mm lime plaster
- 110 mm clay brick inner skin
- 370 mm nominal facing flint with stone rubble infill in lime mortar

PROPOSED IWI:

- 80 mm STEICO internal or equivalent approved rigid wood fibre board fully bonded to levelling coat; lambda value: 0.038 W/mK
- 10 mm internal proprietary mesh reinforced lime based plaster compatible with wood fibre IWI

New U value: 0.30 W/m²K