

EXISTING CONSTRUCTION BUILD-UPS

- 1. VESTRY SUSPENDED TIMBER FLOOR**  
- Carpet finish  
- 22 mm chipboard flooring  
- 150 x 50 mm timber joists @ 400 mm centres with fibre insulation between  
**U value: 0.30 W/m2K**
- 2. SOLID FLOOR**  
- Linoleum finish  
- 18 mm plywood floating floor  
- 75 mm XPS insulation  
- Nominal 150 mm cement screed / concrete oversite slab  
**U value: 0.89 W/m2K**
- 3. VESTRY SOLID WALL**  
- 20 mm lime plaster  
- 110 mm clay brick inner skin  
- 370 mm nominal facing flint with stone rubble infill in lime mortar  
**U value: 0.65 W/m2K**
- 4. CAVITY WALL**  
- 20 mm cement plaster  
- 100 mm concrete block inner leaf  
- 65 mm injected PU foam cavity insulation  
- 110 mm clay brick outer leaf  
- 15 cement render  
**U value: 0.32 W/m2K**
- 5. 'PARTY' WALL TO CHURCH**  
- 15 mm gypsum plasterboard and skim  
- 100 x 50 mm timber framing @ average 400 mm centres with 'Warmcel' cellulose insulation infill  
- Minimum 200 mm cavity with 'Warmcel' cellulose insulation infill  
- 370 mm nominal facing flint with stone rubble infill in lime mortar  
- 110 mm clay brick inner skin  
**U value: 0.12 W/m2K**
- 6. KITCHEN SOLID WALL**  
- 15 mm gypsum plasterboard and skim  
- 50 mm EPS insulation IWI  
- 230 mm clay brick outer leaf  
- 15 cement render  
**U value: 0.55 W/m2K**
- 7. VESTRY ROOF**  
- 15 mm gypsum plasterboard and skim  
- 50 mm EPS insulation lining to underside timber rafters @ nominal 400 mm centres (no insulation between rafters)  
**U value: 0.66 W/m2K**
- 8. MAIN ROOF**  
- 15 mm gypsum plasterboard and skim on battened service zone and 'Intello' airtight vapour control membrane  
- 15 mm gypsum plasterboard and skim  
- 100 x 50 mm timber ceiling joists @ nominal 400 mm centres with 'Warmcel' cellulose insulation infill  
- 300 mm 'Warmcel' cellulose insulation over  
- Ventilated loft space  
**U value: 0.10 W/m2K**
- 9. WINDOWS AND GLAZED EXTERNAL DOORS**  
- Rational AURA PLUS triple glazed timber / aluminium composite  
**Average U value: 0.99 W/m2K**

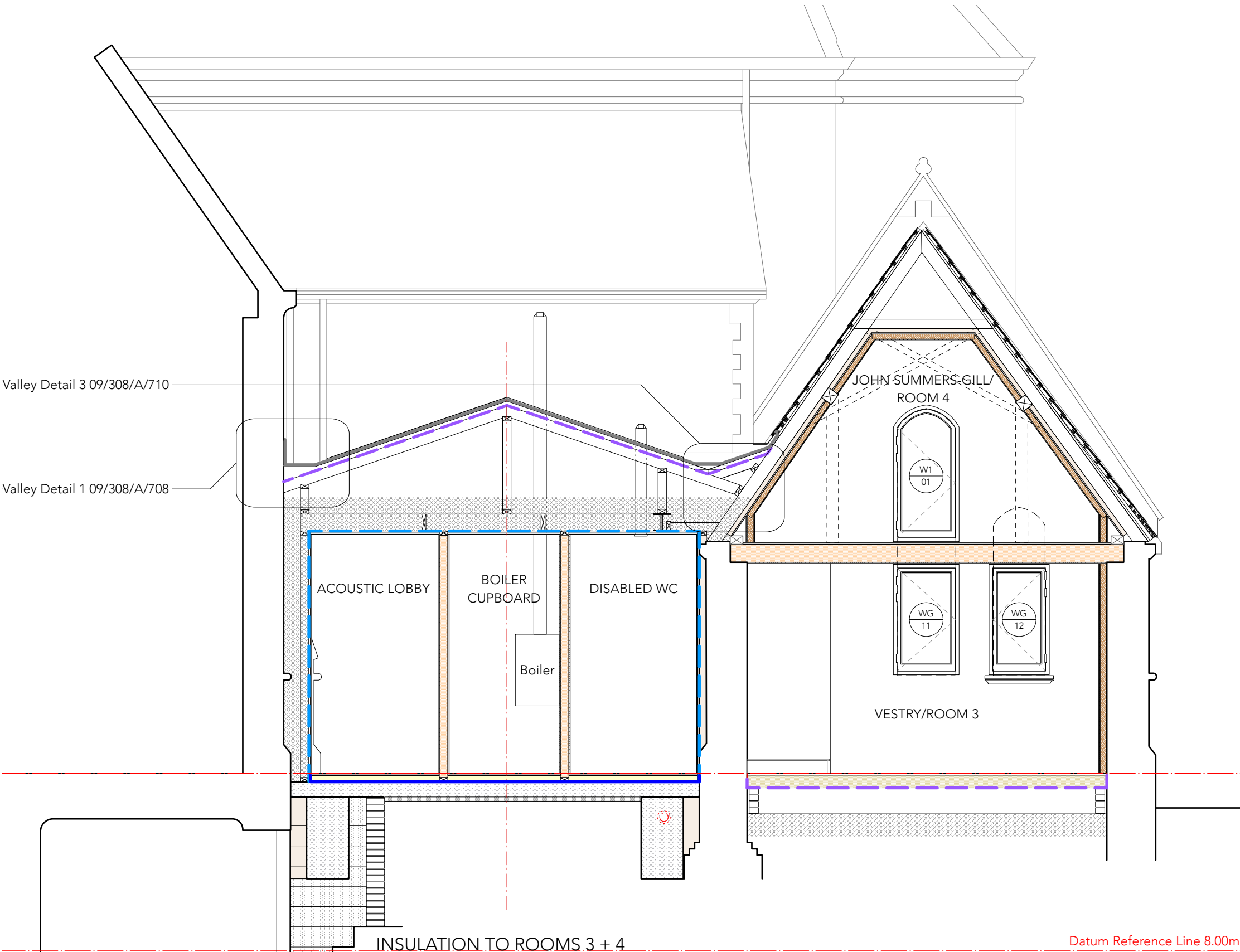

1. RIGID WOOD FIBRE IWI TO EXTERNAL WALLS

- EXISTING SOLID WALL:  
- 20 mm lime plaster  
- 110 mm clay brick inner skin  
- 370 mm nominal facing flint with stone rubble infill in lime mortar  
PROPOSED IWI:  
- 80 mm STEICOinternal or equivalent approved rigid wood fibre board fully bonded to levelling coat; lambda value: 0.038 W/mK  
- 10 mm internal proprietary mesh reinforced lime based plaster compatible with wood fibre IWI  
**New U value: 0.30 W/m2K**

2. ROOM 4 CEILING LINING

- EXISTING VESTRY ROOF:  
- 15 mm gypsum plasterboard and skim  
- 50 mm EPS insulation lining to underside timber rafters @ nominal 400 mm centres (no insulation between rafters)  
PROPOSED INSULATION LINING:  
- 60 mm STEICOinternal or equivalent approved rigid wood fibre board fully bonded to levelling coat; lambda value: 0.038 W/mK  
- 10 mm internal proprietary mesh reinforced lime based plaster compatible with wood fibre IWI  
**U value: 0.35 W/m2K**

T2	03.07.25	IWI and secondary double glazing windows to Room 3 + 4 added	AG
T1	24.03.25	Tender issue	AG
P1	07.03.25	Initial issue	AG
Rev	Date	Amendment	By Chkd

0 1 2 3 metres

SECTION AA THROUGH VESTRY & LINK EXTENSION

Proposed ASHP - St Andrew's Centre, Hertford

Scale 1:50 @ A3 Date Mar 2025 Drawing no. 25\_413 | L | 010\_T2